

## Quietspace Soundsorb

An innovative solution for optimal acoustic performance, Quietspace Soundsorb combines the sustainability and natural acoustic benefits of Durra Panel with the compressed face and cushioned backing of Autex Quietspace® which provides NRC 0.85. Elevate the auditory experience of your space while keeping it sophisticated with the classic neutral colour pallet.

**Quietspace is available in the following colours.**



Black

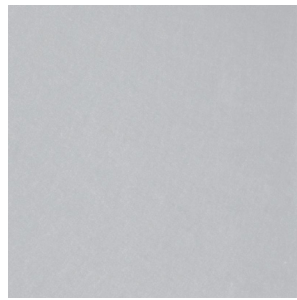

Grey



White

# Typical Detail

## Durra Ceiling System Section

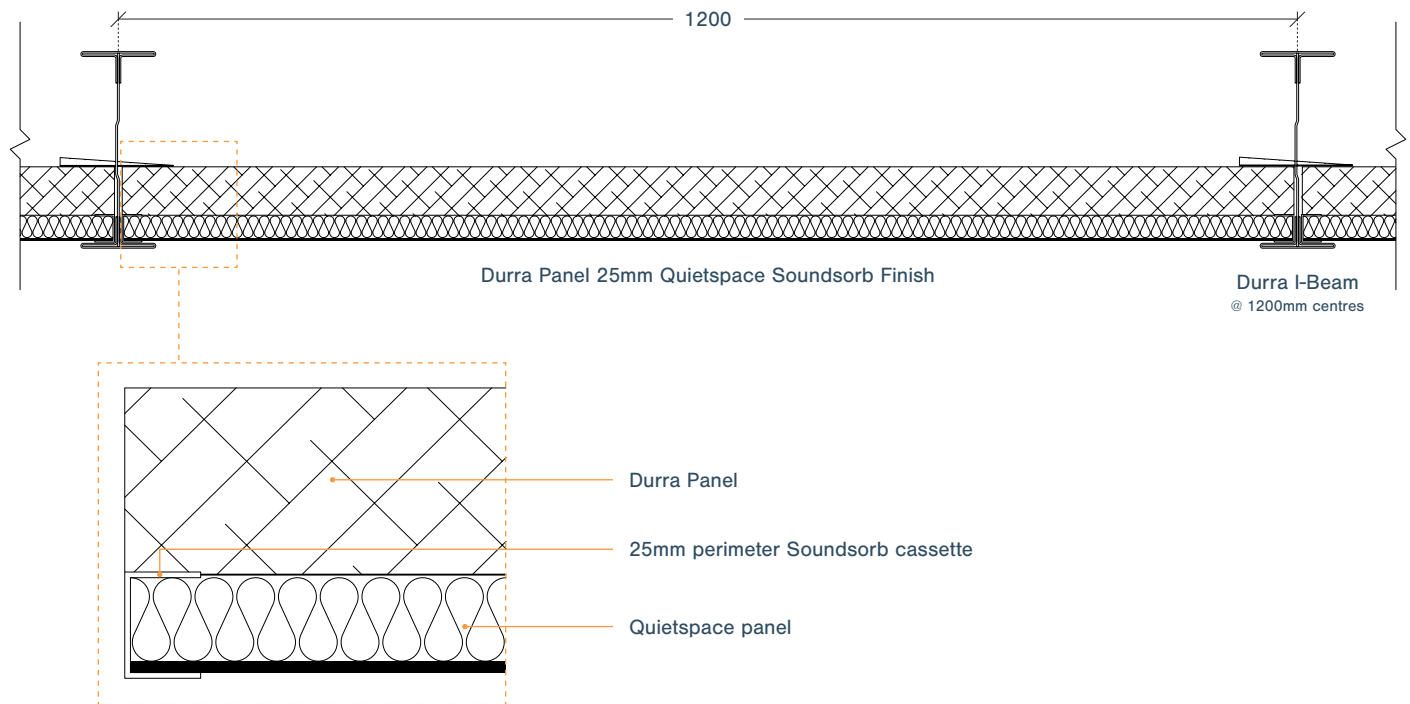

## Reflected Ceiling Plan - typical grid size 2400 x 1200mm

